

DISTRIBUTED BY:  
Pro Wood Finishes  
14622 Southlawn Lane  
Rockville MD 20850  
Ph: (301) 424-3033

Festool GmbH  
Wertstraße 20  
D-73240 Wendlingen  
Tel.: +49 (0)7024/804-0  
Telefax: +49 (0)7024/804-20608  
www.festool.com

# FESTOOL

## **Instruction manual - Cordless drill**

Page 6

**IMPORTANT:** Read all instructions before using.

## **Guide d'utilisation - Perceuses-visseuses sans fil**

Page 16

**IMPORTANT:** Lire toutes les instructions avant de démarrer les travaux.

## **Manual de instrucciones - Taladro atornillador de batería**

Página 27

**IMPORTANTE:** Lea todas las instrucciones antes de usar.

**Instruction manual  
Guide d'utilisation  
Manual de instrucciones**

# T 18+3 Li



708358\_001



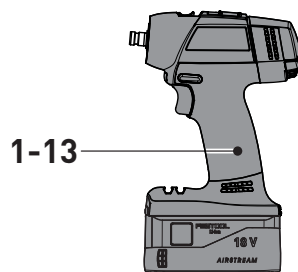
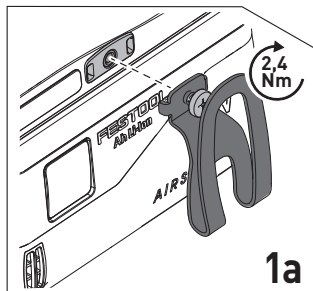
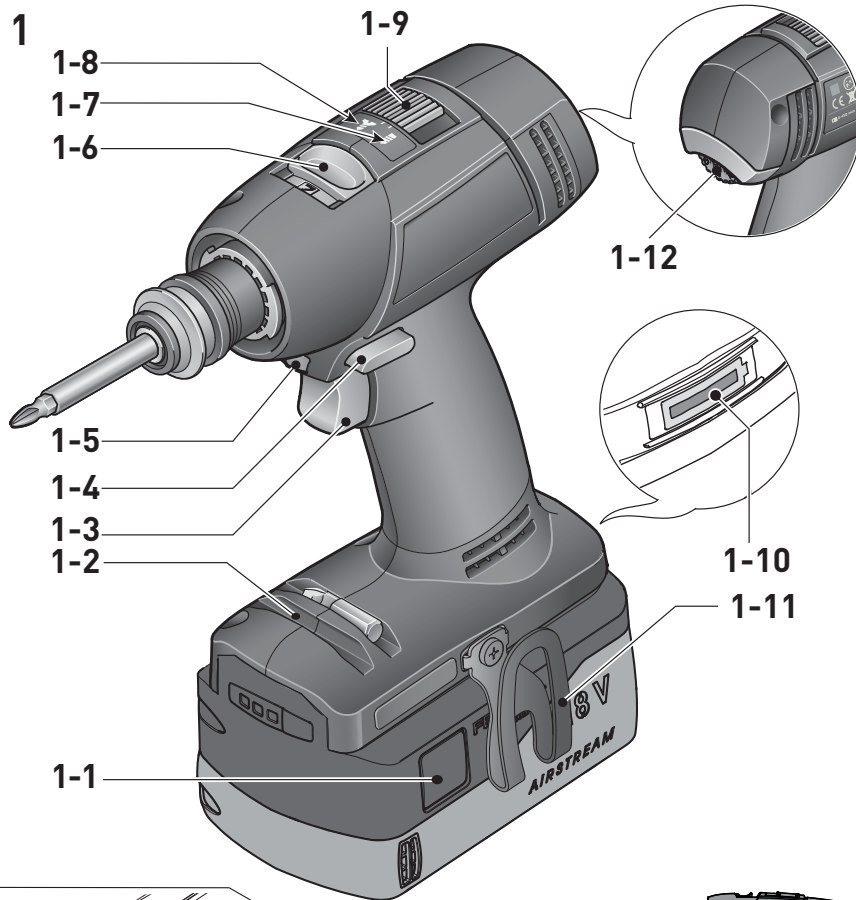



## Contents



About this manual.....	6	Fastening .....	11
Symbols.....	6	Drilling.....	11
Safety instructions .....	7	Tool holder, attachments.....	11
General safety instructions .....	7	CENTROTEC tool chuck [3] .....	12
Machine-specific safety notices for cordless drills .....	9	Chuck BF-FX [4] .....	12
Health hazard by dust .....	9	Angle attachment DD-AS [5] .....	12
Intended use .....	9	Eccentric attachment DD-ES [6] .....	13
Technical data .....	9	Tool holder in the drill spindle [7] .....	13
Functional description .....	10	Working with the power tool .....	13
Commissioning .....	10	On/Off switch [1-3] .....	13
Belt clip .....	10	Bit store [1-2].....	13
Changing the battery pack Fig. 2.....	10	Acoustic warning signals .....	13
Settings .....	11	Service and maintenance .....	14
Changing direction of rotation [1-4] ....	11	Accessories .....	14
Changing gear [1-6].....	11	Environment .....	15

## About this manual

### Save these instructions



It is important for you to read and understand this manual. The information it contains relates to protecting **your safety** and **preventing problems**. The symbols below are used to help you recognize this information.

	<b>DANGER</b>	Description of imminent hazard and failure to avoid hazard will result in death.
	<b>WARNING</b>	Description of hazard and possible resulting injuries or death.
	<b>CAUTION</b>	Description of hazard and possible resulting injuries.



	<b>NOTICE</b>	Statement including nature of hazard and possible result.
	<b>HINT</b>	Indicates information, notes, or tips for improving your success using the tool.





## Symbols

### Symbol Significance

	Warning of general danger
	Risk of electric shock
	Read operating instructions and safety notices!

### Symbol Significance

	Wear ear protection.
	Wear protective gloves.
	Wear a dust mask.

Symbol Significance	
	Wear protective goggles.
	Tip or advice
	Handling instruction
	diameter
	Max. chuck clamping
$\phi$ max.	
V	volts
A	amperes
Hz	hertz
~ a.c.	alternating current
--- d.c.	direct current

$n_0$	no load speed
rpm	revolutions per minute
$\text{min}^{-1}$	
tr/mn	
$^{\circ}\text{C}$	degree Celsius
min.	minutes
Ah	amps hour
kg	kilograms
Wh	watt hour
lb.	pound
mm	millimetre
"	inch
Nm	Newton metre

## Safety instructions

### General safety instructions

 **WARNING! Read all safety warnings and all instructions.** Failure to follow the warnings and instructions may result in electric shock, fire and/or serious injury.

**Save all warnings and instructions for future reference.**

The term "power tool" in the warnings refers to your mains-operated (corded) power tool or battery-operated (cordless) power tool.

#### 1 WORK AREA SAFETY

- Keep work area clean and well lit.** Cluttered and dark areas invite accidents.
- Do not operate power tools in explosive atmospheres, such as in the presence of flammable liquids, gases or dust.** Power tools create sparks which may ignite the dust or fumes.
- Keep children and bystanders away while operating a power tool.** Distractions can cause you to lose control.

#### 2 ELECTRICAL SAFETY

- Power tool plugs must match the outlet. Never modify the plug in any way. Do not use any adapter plugs with earthed (grounded) power tools.** Unmodified plugs and matching outlets will reduce risk of electric shock.
- Avoid body contact with earthed or grounded surfaces, such as pipes, radiators, ranges and refrigerators.** There is an increased risk of elec-

tric shock if your body is earthed or grounded.

- Do not expose power tools to rain or wet conditions.** Water entering a power tool will increase the risk of electric shock.
- Do not abuse the cord. Never use the cord for carrying, pulling or unplugging the power tool. Keep cord away from heat, oil, sharp edges or moving parts.** Damaged or entangled cords increase the risk of electric shock.
- When operating a power tool outdoors, use an extension cord suitable for outdoor use.** Use of a cord suitable for outdoor use reduces the risk of electric shock.
- If operating a power tool in a damp location is unavoidable, use a residual current device (RCD) protected supply.** Use of an RCD reduces the risk of electric shock.

#### 3 PERSONAL SAFETY

- Stay alert, watch what you are doing and use common sense when operating a power tool. Do not use a power tool while you are tired or under the influence of drugs, alcohol or medication.** A moment of inattention while operating power tools may result in serious personal injury.
- Use personal protective equipment. Always wear eye protection.** Protective equipment such as dust mask, non skid safety shoes, hard hat, or hearing protection used for appropriate conditions will reduce personal injuries.
- Prevent unintentional starting. Ensure the switch is in the off-position before connecting to**

- power source and/or battery pack, picking up or carrying the tool.** Carrying power tools with your finger on the switch or energising power tools that have the switch on invites accidents.
- d. **Remove any adjusting key or wrench before turning the power tool on.** A wrench or a key left attached to a rotating part of the power tool may result in personal injury.
  - e. **Do not overreach. Keep proper footing and balance at all times.** This enables better control of the power tool in unexpected situations.
  - f. **Dress properly. Do not wear loose clothing or jewellery. Keep your hair, clothing and gloves away from moving parts.** Loose clothes, jewellery or long hair can be caught in moving parts.
  - g. **If devices are provided for the connection of dust extraction and collection facilities, ensure these are connected and properly used.** Use of dust collection can reduce dust-related hazards.
  - h. **Do not let familiarity gained from frequent use of tools allow you to become complacent and ignore, tool safety principles.** A careless action can cause severe injury within a fraction of a second.

#### 4 POWER TOOL USE AND CARE

- a. **Do not force the power tool. Use the correct power tool for your application.** The correct power tool will do the job better and safer at the rate for which it was designed.
- b. **Do not use the power tool if the switch does not turn it on and off.** Any power tool that cannot be controlled with the switch is dangerous and must be repaired.
- c. **Disconnect the plug from the power source and/or battery pack from the power tool before making any adjustments, changing accessories, or storing power tools.** Such preventive safety measures reduce the risk of starting the power tool accidentally.
- d. **Store idle power tools out of the reach of children and do not allow persons unfamiliar with the power tool or these instructions to operate the power tool.** Power tools are dangerous in the hands of untrained users.
- e. **Maintain power tools. Check for misalignment or binding of moving parts, breakage of parts and any other condition that may affect the power tool's operation. If damaged, have the power**

**tool repaired before use.** Many accidents are caused by poorly maintained power tools.

- f. **Keep cutting tools sharp and clean.** Properly maintained cutting tools with sharp cutting edges are less likely to bind and are easier to control.
- g. **Use the power tool, accessories and tool bits etc. in accordance with these instructions taking into account the working conditions and the work to be performed.** Use of the power tool for operations different from those intended could result in a hazardous situation.
- h. **Keep handles dry, clean and free from oil and grease.** Slippery handles do not allow for safe handling and control of the tool in unexpected situations.

#### 5 BATTERY TOOL USE AND CARE

- a. **Recharge only with the charger specified by the manufacturer.** A charger that is suitable for one type of battery pack may create a risk of fire when used with another battery pack.
- b. **Use power tools only with specifically designated battery packs.** Use of any other battery packs may create a risk of injury and fire.
- c. **When battery pack is not in use, keep it away from other metal objects like paper clips, coins, keys, nails, screws, or other small metal objects that can make a connection from one terminal to another.** Shorting the battery terminals together may cause burns or a fire.
- d. **Under abusive conditions, liquid may be ejected from the battery; avoid contact. If contact accidentally occurs, flush with water. If liquid contacts eyes, additionally seek medical help.** Liquid ejected from the battery may cause irritation or burns.
- e. **Do not use a battery pack or tool that is damaged or modified.** Damaged or modified batteries may exhibit unpredictable behaviour resulting in fire, explosion or risk of injury.
- f. **Do not expose a battery pack or tool to fire or excessive temperature.** Exposure to fire or temperature above 130 °C may cause explosion.

#### 6 SERVICE

- a. **Have your power tool serviced by a qualified repair person using only identical replacement parts.** This will ensure that the safety of the power tool is maintained.
- b. **Never service damaged battery packs.** Service of battery packs should only be performed by the manufacturer or authorized service providers.

## Machine-specific safety notices for cordless drills

- **Hold power tool by insulated gripping surfaces, when performing an operation where the cutting accessory or fastener may contact hidden wiring.** Cutting accessory or fasteners contacting a "live" wire may make exposed metal parts of the power tool "live" and could give the operator an electric shock.
- **Use suitable detectors to determine if utility lines are hidden in the work area or call the local utility company for assistance.** Contact with electric lines can lead to fire and electric shock. Damaging a gas line can lead to explosion. Penetrating a water line causes property damage or may cause an electric shock.



- **Wear suitable protection:** such as ear protection, safety goggles, a dust mask for work which generates dust, and protective gloves when working with raw materials and when changing tools.

**CAUTION!** Power tool can block and cause sudden kickback! Switch off immediately!

- Do not lock the on/off switch permanently!
- **Hold the power tool firmly in your hand. Adjust the torque correctly for screwing. Be prepared for a high reaction torque,** which may cause the power tool to turn and possibly lead to injury.

- **Do not use the power tool in the rain or in damp surroundings.** Moisture in the power tool may cause a short circuit and burning.

## Health hazard by dust

**WARNING!** Various dust created by power sanding, sawing, grinding, drilling and other construction activities contains chemicals known (to the State of California) to cause cancer, birth defects or other reproductive harm. Some examples of these chemicals are:

- lead from lead-based paints,
- crystalline silica from bricks and cement and other masonry products, and
- arsenic and chromium from chemically treated lumber.

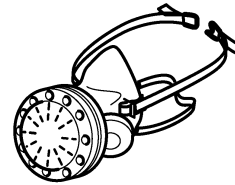

The risk from these exposures varies, depending on how often you do this type of work. To reduce your exposure to these chemicals: work in a well ventilated area, and work with approved safety equipment, such as dust masks that are specially designed to filter out microscopic particles. Wash hands after handling.

**WARNING**  
TO REDUCE THE RISK OF INJURY, USER MUST READ INSTRUCTION MANUAL.

## Intended use

Cordless drill suitable for

- drilling in metal, wood, plastic and similar materials,
- inserting and tightening screws
- use with Festool batteries BPC and BPS of the same voltage.

**WARNING**  
The user bears the responsibility for damage and accidents caused by improper use; this also includes damage and wear caused by continuous use in industry.

## Technical data

Cordless drill	T 18+3 Li	
Motor voltage	18 V	
Idle engine speed*	1st gear	0 - 450 min <sup>-1</sup>
	2nd gear	0 - 1500 min <sup>-1</sup>

Cordless drill		T 18+3 Li
Max. torque	Soft material (wood)	35 Nm
	Hard material (metal)	50 Nm
Adjustable torque**	1st gear	0.8 - 8 Nm
	2nd gear	0.5 - 6 Nm
Chuck clamping range	1/16" - 1/2" (1.5 - 13 mm)	
Drill diameter max.	Wood	1-3/4" (45 mm)
	Metal	5/8" (16 mm)
Tool holder in drill spindle	1/4"	
Weight without battery pack with Centrotec	2.4 lbs (1.1 kg)	

\* Speed specifications with fully charged battery pack.

\*\* The maximum speed is reduced in the lower torque stages (values in counterclockwise rotation).

## Functional description

The pictures for the functional description are on a fold-out page at the beginning of the instruction manual. While reading the manual you can fold out the page for comparison and quick reference.

- [1-1]** Buttons for releasing the battery pack
- [1-2]** Bit store
- [1-3]** On/Off switch
- [1-4]** Right/left switch
- [1-5]** LED lamp
- [1-6]** Gear switch

- [1-7]** Drilling symbol
- [1-8]** Screwdriving symbol
- [1-9]** Drilling/Fastening selector switch
- [1-10]** Capacity display
- [1-11]** Belt clip
- [1-12]** Torque thumbwheel
- [1-13]** Insulated gripping surfaces (grey shaded area)

## Commissioning

Consider the pictures on the fold-out page.

### Belt clip

The belt clip allows a short-term securing of the device in the work clothes. Insert the belt clip on the designated side, right or left, and fix it with the screw **[1a]**.

### Changing the battery pack Fig. 2

ⓘ Battery pack is ready for use immediately upon delivery and can be charged at any time.

The capacity display [1-10] automatically displays the charge state of the battery pack [1-3] when the ON/OFF switch is actuated:

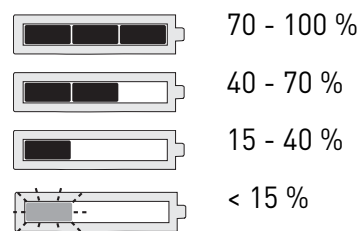

**Recommendation:** Charge battery pack before further use.

### Removing the battery pack

- ▶ Press and hold the button **[2-1]**.
- ▶ Slide the battery pack downwards to remove.

## Inserting the battery pack

- ▶ Slide the battery pack upwards into the machine like shown in **Fig. 2** until it engages.

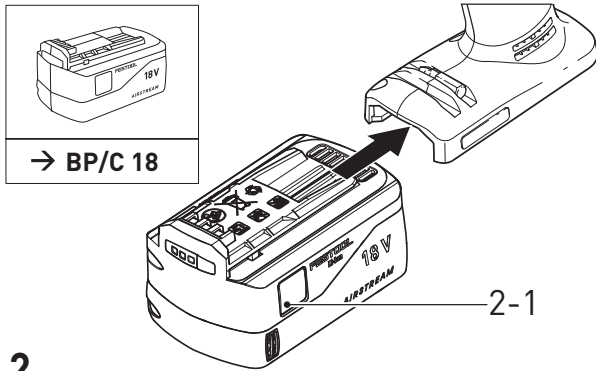

---

## Settings

---

Consider the pictures on the fold-out page.



### CAUTION

#### Risk of injury

- ▶ Always switch off the power tool before adjusting settings!

### Changing direction of rotation [1-4]

- Switch to the left = clockwise rotation
- Switch to the right = counterclockwise rotation

### Changing gear [1-6]

- Gear switch forwards (digit 1 visible) = 1st gear
- Gear switch to rear (digit 2 visible) = 2nd gear

### Fastening

Adjust the switch so that its marking **[1-9]** faces the screw symbol **[1-8]**.

Adjust the torque accordingly at the torque wheel **[1-12]**.

Position 1 = low torque

Position 25 = high torque

An **acoustic signal** sounds when the preset torque is reached and the machine then switches off. You must release and press the ON/OFF switch **[1-3]** again to start the machine.

### Drilling

Adjust the switch so that its marking **[1-9]** faces the drilling symbol **[1-7]** = maximum torque.

---

## Tool holder, attachments

---



### WARNING

#### Risk of injury

- ▶ Always disconnect the battery pack before performing any type of work on the machine!



### CAUTION

#### Hot and sharp tools

#### Risk of injury

- ▶ Do not use insert tools that are blunt or defective.
- ▶ Wear protective gloves.



### CENTROTEC tool chuck [3]

Quick change of tools with CENTROTEC shaft

 Only clamp CENTROTEC tools in CENTROTEC tool chucks.

WH-CE  
CENTROTEC®

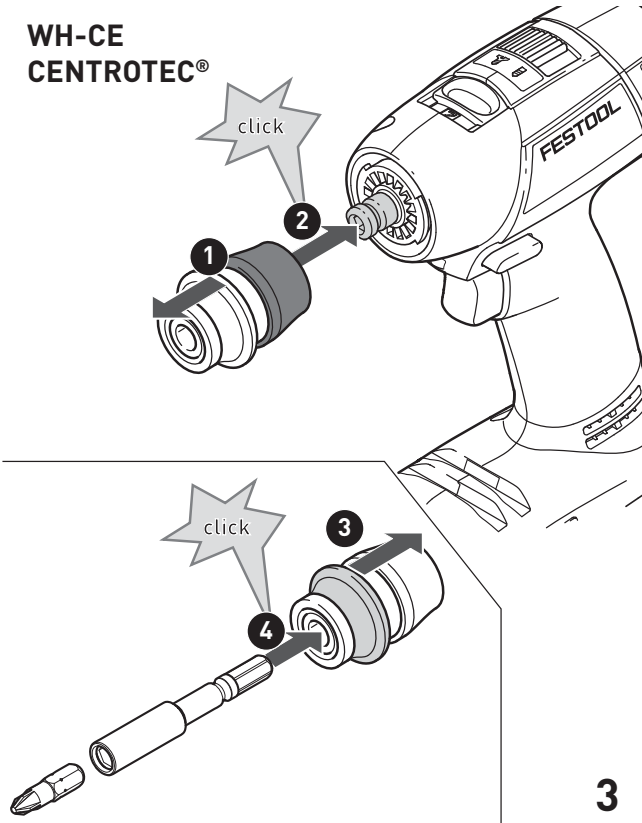

### Chuck BF-FX [4]

For clamping drill bits and bits with max. shaft diameter of 13 mm.

 Clamp tool centrally in the chuck.

BF-FX

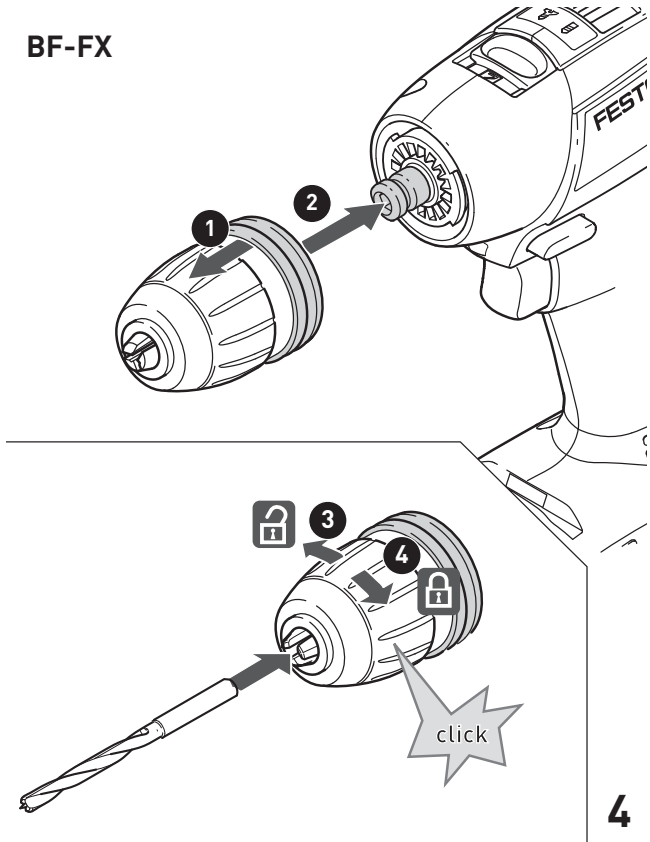

### Angle attachment DD-AS [5]

Drilling and screwing at right angle to machine (partly as an accessory).

DD-AS --- BF-FX  
--- WH-CE

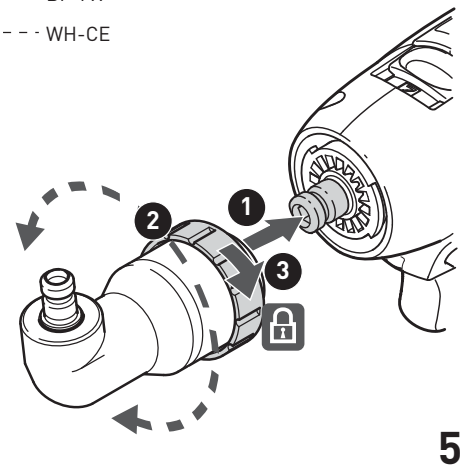

## Eccentric attachment DD-ES [6]

Screwdriving near edges with bits according to ISO 1173 (partly as accessory).

DD-ES

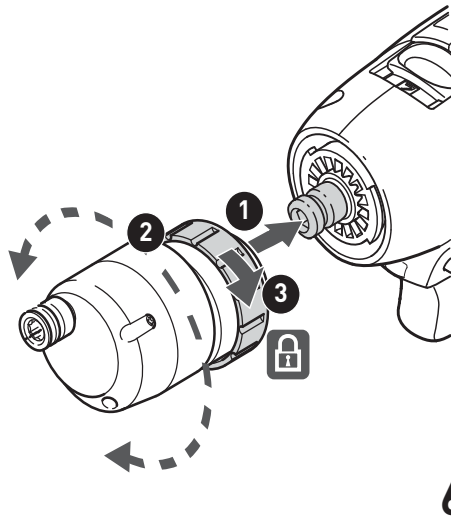

6

## Tool holder in the drill spindle [7]

Bits can be inserted directly into the hexagon socket holder of the drill spindle.

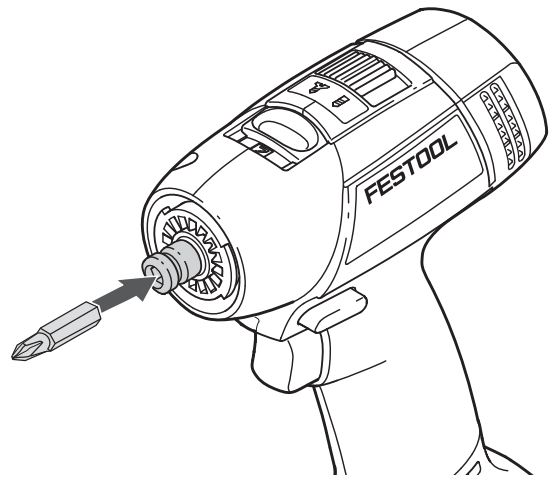

7

## Working with the power tool

Consider the pictures on the fold-out page.



### WARNING

#### Risk of injury

- ▶ Always secure the workpiece in such a manner that it cannot move while being machined.

### On/Off switch [1-3]

Press = ON, release = OFF

- ① The speed of the machine depends on how far the on/off switch is pressed in.

The LED bulb [1-5] lights up when the ON/OFF switch is pressed [1-3].

### Bit store [1-2]

Magnetic, for storing bits and bit holders.

## Acoustic warning signals

Acoustic warning signal sounds and the machine switches off to indicate the following operating states:



peep — —

#### Battery low or machine overloaded.

- Change the battery.
- Reduce machine workload.



peep peep —

#### Machine is overheating.

- You must allow the machine to cool down before further usage.



peep peep peep

#### Battery pack faulty or overheated.

- Once the battery pack has cooled down, perform a function check using the charger.

---

## Service and maintenance

---



### WARNING

**Any maintenance or repair work that requires opening of the motor or gear housing should only be carried out by an authorised Customer Service Centre (name supplied by your dealer)!**

- ▶ Maintenance or repair work carried out by an unauthorised person can lead to the wrong connection of the power cord or other components, which in turn can lead to accidents with serious consequences.



**Customer service and repair** only through manufacturer or service

workshops: Please find the nearest address at: [www.festoolusa.com/service](http://www.festoolusa.com/service)



Use only original Festool spare parts!  
Order No. at:  
[www.festoolusa.com/service](http://www.festoolusa.com/service)

### Observe the following instructions:

- Keep the air slits on the machine and the charger free and clean to ensure adequate cooling.
- Keep the contacts on the machine, charger and battery pack clean.



For service, maintenance, disposal and transport of the battery pack, note enclosed instructions of the battery pack!

---

## Accessories

---

Use only original Festool accessories and Festool consumable material intended for this machine. These components are designed specifically for this machine. Using accessories and consumable material from other suppliers will most likely affect the quality of your results and limit warranty claims. Machine wear or your own personal workload may increase depending on the application.

Protect yourself and your machine, and preserve your warranty claims by always using original Festool accessories and Festool consumable material!

The order numbers of the accessories and tools can be found in the Festool catalogue or on the Internet under "[www.festoolusa.com](http://www.festoolusa.com)".

## Systainer

Many Festool products are shipped in a unique system container, called "Systainer". This provides protection and storage for the tool and accessories. The Systainers are stackable and can be interlocked together. They also can be interlocked atop Festool CT dust extractors.

### To open the Systainer



Turn the T-loc [8-1] to this position.

### To lock the Systainer



Turn the T-loc [8-1] to this position.

### To connect two Systainers

Place one Systainer on the top of the other (Fig. [8A]).



Turn the T-loc [8-1] to one of this positions (Fig. [8B]).

The Systainers are connected and locked.

- ① A new generation Systainer is connectable on top of a previous generation Systainer by the four latches of the previous Systainer.

8

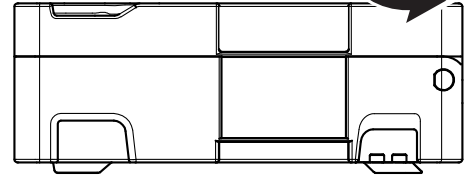
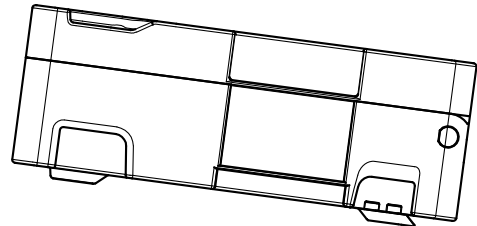

A

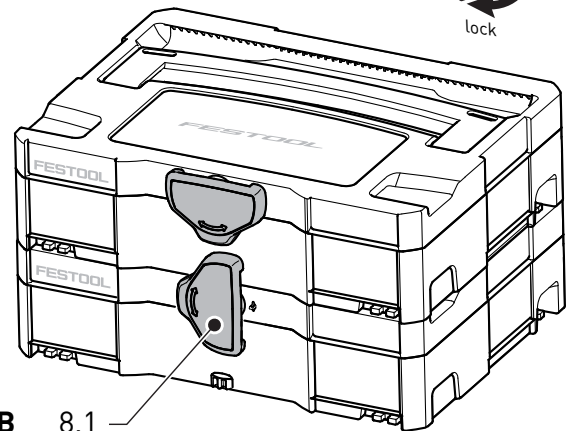
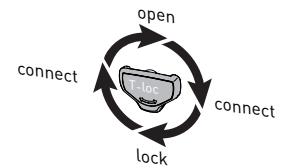

B 8.1

---

## Environment

---

**Do not dispose of the device as domestic waste!**  
Dispose of machines, accessories and packaging at

an environmentally responsible recycling centre.  
Observe the respective national regulations.